

SECTION AA

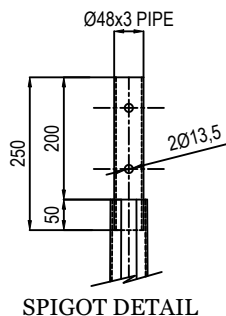

SPIGOT DETAIL

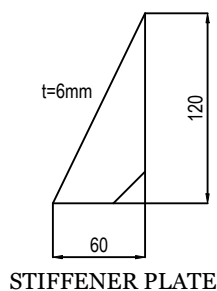

STIFFENER PLATE

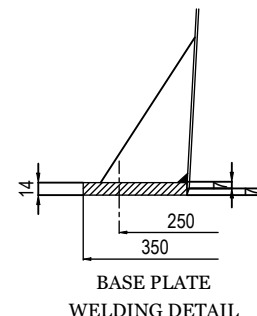

BASE PLATE WELDING DETAIL

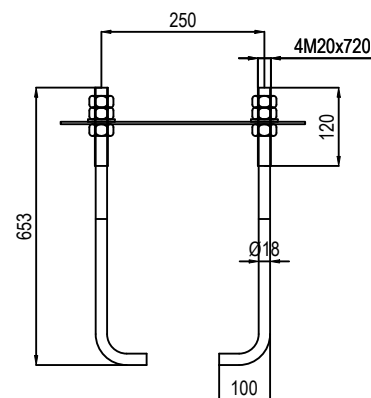

ANCHOR BOLT

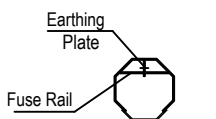

SECTION BB

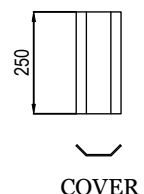

COVER

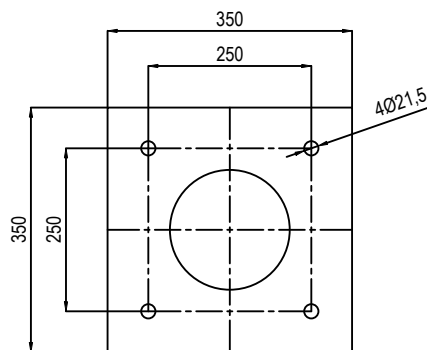

BASE TEMPLATE

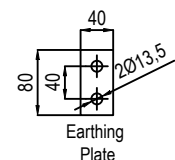

Earthing Plate

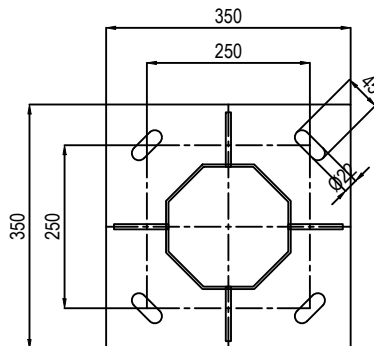
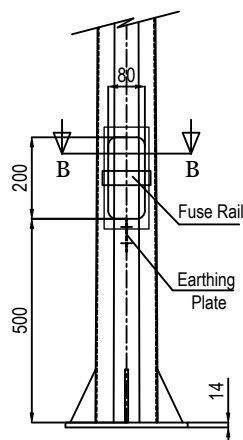

BASE PLATE
#14x350x350

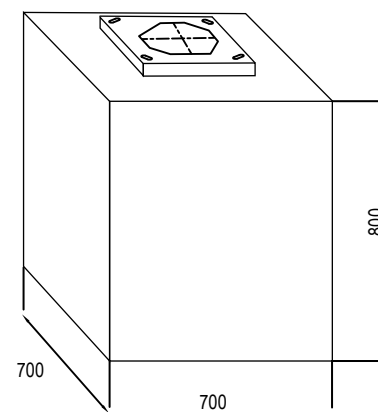

Dimensiunile recomandate pentru fundație



București-România
Bd. Iuliu Maniu, nr. 616, sec. 6
tel:021 352 1554 / 55
mail:vanzari@spotvisionlighting.ro
www.spotvisionlighting.ro

STÂLP OCTOGONAL CU FLANȘĂ 12M

- 1- Dacă nu se specifică altfel, toate dimensiunile sunt în mm;
- 2- Stâlpii sunt fabricați în conformitate cu EN40;
- 3- Materiale:
 - 3.1 Pentru stâlpi și alte materiale EN 10025 Calitatea oțelului este S235 JR
 - 3.2 Șuruburi de ancorare clasa 1040
 - 3.3 Toate șuruburile, piulițele, șuruburile din oțel de calitate ISO 4016
- 4- Galvanizare la cald conform ENISO 1461/ASTM A123;
- 5- Rezistență viteză vânt 130km/h;